

FASTEST QUICK CONNECTORS: LEAK & PRESSURE TESTING

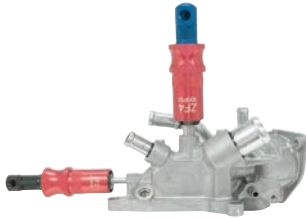

1079

EZ Connect ZN Series



1080

EZ Connect ZF Series



1082

FE Series External Connectors



1083

FI Series Internal Connectors

FASTEST QUICK CONNECTORS: LEAK & PRESSURE TESTING



1085

JNL / JXL Series



1086

FasMate FX / FN Series



1088

TwistMate MET / MIT Series



MANUFACTURING

Industry leading quick connectors for leak and pressure testing during the manufacturing process.

HVAC-R

High flow OEM refrigerant valves for HVAC-R manufacturers and connectors for testing applications with refrigerant tubing and process tips.

COMPRESSED GAS

High speed CGA standard connectors for filling of medical and industrial oxygen, propane and other compressed gas cylinders.

CALIBRATION

Calibrate faster with connectors for gauges, transmitters, control valve actuators, transducers, instrumentation, compression fittings, flanges, conduit and piping.

MEDICAL

Automated pneumatic and manual quick connectors for volume testing of luers, tubing, syringes, catheters and other medical device components.

AUTOMOTIVE

Leak and pressure testing quick connectors for engines and automotive components.

FLUID POWER

Precision quick connectors for leak testing of critical fluid power components or transferring of fluids into/out of a system.

AEROSPACE

Industry leading precision quick connectors for leak testing of a wide range of aerospace components.

APPLIANCES

Quick connectors for leak testing compressors, water systems, coils, heat exchangers and other appliance components.

DESCRIPTION

FasTest's EZ Series seal adjustable connectors provide fast, leak tight connections for pressure and vacuum testing, fluid filling and flushing applications from vacuum to 50 psi (3.44 bar). The industry best EZ Series seal connectors deliver fast, efficient seals by moving the bi-directional handle in either direction.

FEATURES

- Simple adjustment – twist to adjust collar is easily sized for various seal diameters
- Quick change seal sets to accommodate multiple size tubing and port applications
- Simple design and 5 TIME field service maintenance kits require no special tools for easy seal replacement
- High flow design can be quickly adapted for plug style applications

APPLICATIONS

- Radiators, hoses, reservoirs, plastic moulded components
- Plumbing fixtures, fuel tanks, pumps, filters, castings, fabricated housings
- Hydronic heating, engines, axles, transmissions, small appliances
- Pumps, tubing and assemblies

SPECIFICATIONS

Connection type	Internal tubes / bores
Connection method	Lever actuated
Pressure rating	50 psi (3.4 bar)
Test pressure	Vacuum to 50 psi / 3.44 bar (clean and dry surface pneumatic applications)

MATERIALS

Housing materials	Aluminium, stainless steel and moulded nylon handle
Seals	Neoprene (main), Buna-N (internal)



INTERNAL MANUAL TUBE CONNECTOR



LEVER ACTUATED WITH NEOPRENE MAIN SEALS

6410

PART NUMBER	SEALING RANGE	TERMINATION	BODY SIZE	PRICE
FASZN101	0.375" – 0.394"	1/8" NPT	1	£191.27
FASZN111	0.394" – 0.472"	1/8" NPT	1	£191.27
FASZN112	0.472" – 0.551"	1/8" NPT	1	£191.27
FASZN113	0.551" – 0.630"	1/8" NPT	1	£191.27
FASZN221	0.630" – 0.709"	1/4" NPT	2	£201.08
FASZN222	0.709" – 0.787"	1/4" NPT	2	£201.08
FASZN223	0.787" – 0.866"	1/4" NPT	2	£201.08
FASZN331	0.866" – 0.945"	1/4" NPT	3	£242.76
FASZN332	0.945" – 1.024"	1/4" NPT	3	£242.76
FASZN333	1.024" – 1.102"	1/4" NPT	3	£242.76
FASZN441	1.102" – 1.181"	3/8" NPT	4	£290.58
FASZN442	1.181" – 1.260"	3/8" NPT	4	£290.58
FASZN443	1.260" – 1.339"	3/8" NPT	4	£290.58

MAINTENANCE KIT



ZN SERIES MAINTENANCE KIT 5 COMPLETE REFURBISHMENTS

6410

PART NUMBER	FOR USE WITH	PRICE
FASZNB1-0360	FASZN101	£141.39
FASZNB111	FASZN111	£80.92
FASZNB112	FASZN112	£80.92
FASZNB113	FASZN113	£80.92
FASZNB221	FASZN221	£80.92
FASZNB222	FASZN222	£80.92
FASZNB223	FASZN223	£80.92
FASZNB331	FASZN331	£101.76
FASZNB332	FASZN332	£101.76
FASZNB333	FASZN333	£101.76
FASZNB441	FASZN441	£104.22
FASZNB442	FASZN442	£104.22
FASZNB443	FASZN443	£104.22

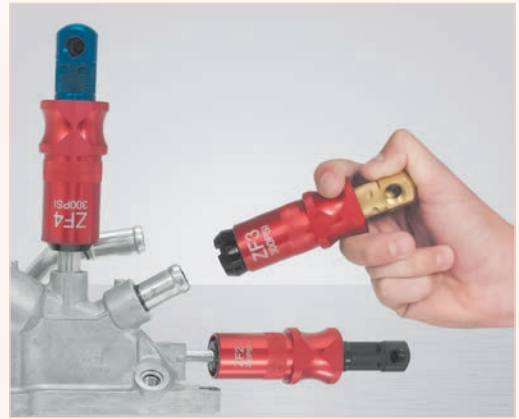
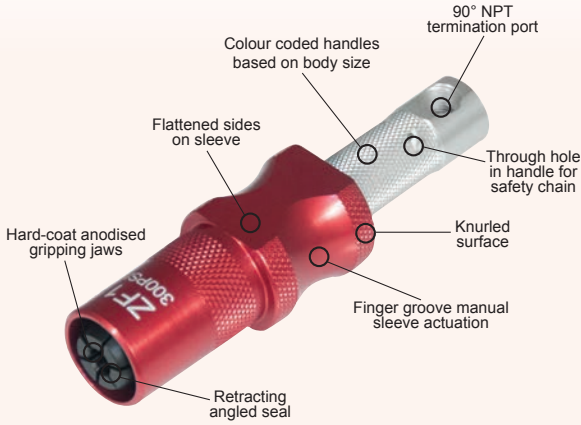

SPECIFICATIONS

Operating pressure	Vacuum to 21 bar / 300 psi (ZF1-ZF4) 17 bar / 250 psi (ZF5)
Connection profile	External formed tubes (SAE J1231)
Termination profile	1/8" to 3/8" NPT
Operating temperature	-17°C to +93°C (0°F to 200°F)
Min / max bead depth (C)	0.13" / 0.32" (3.3 mm / 8.1 mm)
Minimum clearance (D)	0.31" (7.9 mm)
MATERIALS	
Housing, sleeve & components	Anodised aluminium
Main seal	70 durometer neoprene

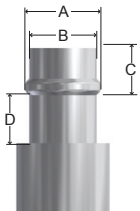

EZ Connect ZF incorporates a manual sleeve actuation to create a leak-tight external connection to a wide variety of formed tube styles. The ZF connectors are ideal for a diverse range of manufacturing testing systems.

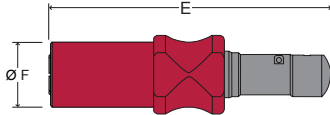

CONNECTOR	(E)	(Ø F)
ZF1	4.60" (116 mm)	0.98" (24.8 mm)
ZF2	4.90" (124 mm)	1.14" (28.9 mm)
ZF3	4.96" (126 mm)	1.23" (31.2 mm)
ZF4	5.18" (131 mm)	1.38" (35.0 mm)
ZF5	5.25" (133 mm)	1.55" (39.4 mm)

BODY SIZE	Ø BEAD DIA. RANGE (A)	TUBE DIA. RANGE (B)	SAE J1231	RATED PSI	TERMINATION PORT (90°)	Ø FLOW DIA.	MAIN SEAL PACK	REPAIR KIT
ZF1	Ø 0.310" – 0.400" 7.87mm – 10.16mm	Ø 0.25" – 0.34" 6.54mm – 8.74mm	-5	300	1/8" NPT	Ø 0.17" 4.3 mm	S-ZF1	R-ZF1
ZF2	Ø 0.400" – 0.490" 10.2mm – 12.4mm	Ø 0.34" – 0.44" 8.7mm – 11.0mm	-6	300	1/8" NPT	Ø 0.19" 4.8 mm	S-ZF2	R-ZF2
ZF3	Ø 0.490" – 0.580" 12.4mm – 14.7mm	Ø 0.44" – 0.52" 11.0mm – 13.2mm	-7 & -8	300	1/4" NPT	Ø 0.21" 5.3 mm	S-ZF3	R-ZF3
ZF4	Ø 0.580" – 0.670" 14.7mm – 17.0mm	Ø 0.52" – 0.61" 13.2mm – 15.5mm	-9	300	1/4" NPT	Ø 0.32" 8.1 mm	S-ZF4	R-ZF4
ZF5	Ø 0.670" – 0.760" 17.0mm – 19.3mm	Ø 0.61" – 0.70" 15.5mm – 17.8mm	-10	250	3/8" NPT	Ø 0.38" 9.6 mm	S-ZF5	R-ZF5

Colour coded handles simplifying operator selection when multiple SAE tube sizes are present

DESCRIPTION

FasTest's EZ Connect ZF connectors provide fast, leak tight connections for pressure and vacuum testing, fluid filling and flushing applications from vacuum to 300 psi (20.68 bar). EZ Connect ZF is the newest quick connector in the EZ Connect Series and is designed to provide instant connections to a wide range of formed tube configurations for in-process testing.

FEATURES

- Wide tolerance seal design provides fit to a range of tube diameters
- Lightweight aluminium body puts less strain on operator
- Finger grooves create an intuitive one-hand operation
- Self-aligning connector reduces connection failures
- Colour coded handles help operator identify correct connector
- Connectors fit in tight placements, providing improved fixture possibilities

APPLICATIONS

- Engines and manifolds
- Radiators and reservoirs
- Castings
- Small appliances
- Lawn and garden products
- Plastic barbed tubes

SPECIFICATIONS

Connection type	External tubes
Connection method	Sleeve actuated
Pressure ratings	F1-4: 300 psi (20.6 bar), F5: 250 psi (17.23 bar)
MATERIALS	
Seals	Neoprene

EXTERNAL MANUAL TUBE CONNECTORS

SLEEVE ACTUATED RED / SILVER



6410

PART NUMBER	SEALING RANGE	TERMINATION	BODY SIZE	PRICE
FASZF1	0.254" – 0.344"	1/8" NPT	ZF1	£795.72

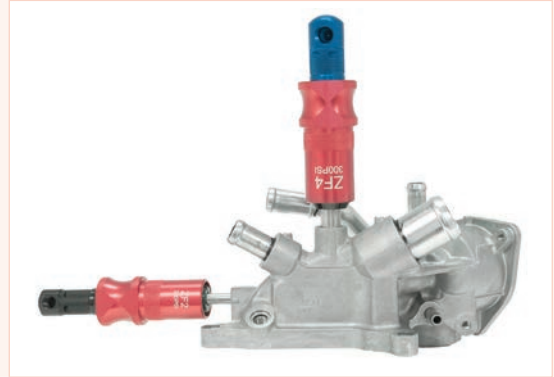

SLEEVE ACTUATED RED / BLACK



6410

PART NUMBER	SEALING RANGE	TERMINATION	BODY SIZE	PRICE
FASZF2	0.344" – 0.434"	1/8" NPT	ZF2	£814.12

SLEEVE ACTUATED RED / BLUE



6410

PART NUMBER	SEALING RANGE	TERMINATION	BODY SIZE	PRICE
FASZF4	0.520" – 0.610"	1/4" NPT	ZF4	£918.33

SLEEVE ACTUATED RED / GOLD



6410

PART NUMBER	SEALING RANGE	TERMINATION	BODY SIZE	PRICE
FASZF3	0.434" – 0.520"	1/4" NPT	ZF3	£857.03

SLEEVE ACTUATED RED / GREEN



6410

PART NUMBER	SEALING RANGE	TERMINATION	BODY SIZE	PRICE
FASZF5	0.61" – 0.70"	3/8" NPT	ZF5	£1028.68

REPLACEMENT SEAL SET



SEAL SET 5 SEALS

6410

PART NUMBER	FOR USE WITH	PRICE
FASSZF1	FASZF1	£88.28
FASSZF2	FASZF2	£88.28
FASSZF3	FASZF3	£88.28
FASSZF4	FASZF4	£88.28
FASSZF5	FASZF5	£88.28

PUR seals available on request

REPAIR KIT

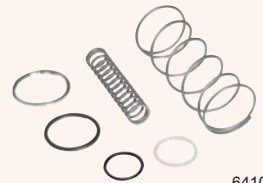

REPAIR KIT

6410

PART NUMBER	FOR USE WITH	PRICE
FASRZF1	FASZF1	£45.36
FASRZF2	FASZF2	£45.36
FASRZF3	FASZF3	£45.36
FASRZF4	FASZF4	£45.36
FASRZF5	FASZF5	£45.36

DESCRIPTION

FasTest External (FE) connectors deliver fast, leak free connections for vacuum and pressure testing, fluid filling or flushing applications. The FE quick connectors seal externally to a wide variety of smooth or threaded tubes, and the uniform seal movement makes a leak tight, quick connection, even over threaded, rough and oily surfaces. The connectors are ideal for automated processes and high volume production testing. Compressed air activates the seals for a full flow test with air, gas or liquid. Ideally suited to pick and place parts handling applications.

SPECIFICATION

Connection type	External tubes
Connection method	Automated pneumatic
Pressure rating	500 psi (34.4 bar)
Test pressure	Vacuum to 500 psi
Pilot operation	60 to 90 psi air supply

MATERIALS

Housing materials	Aluminium and stainless steel
Seal material	Neoprene

EXTERNAL TUBE & THREAD



6410

BASE CONNECTOR WITHOUT SEALS

PART NUMBER	SEALING RANGE	TERMINATION	BODY SIZE	PRICE
FASFEM001	0.050" – 0.080"	1/8" BSPP	001	POA
FASFEM01	0.100" – 0.510"	1/8" BSPP	01	£399.70
FASFEM1	0.433" – 0.827"	1/4" BSPP	1	£523.53
FASFEM2	0.787" – 1.510"	1/2" BSPP	2	£637.56
FASFEM3	1.496" – 1.969"	1" BSPP	3	£1048.30
FASFEM4	1.969" – 3.032"	1 1/8" BSPP	4	£1309.07

REPAIR KIT



6410

INTERNAL REPAIR KIT WITH NEOPRENE PISTON O-RINGS

PART NUMBER	FOR USE WITH	PRICE
FASFER001	FASFEM001	£14.71
FASFER01	FASFEM01	£17.17
FASFER1	FASFEM1	£17.17
FASFER2	FASFEM2	£18.39
FASFER3	FASFEM3	£33.10
FASFER4	FASFEM4	£36.78

SEAL SETS

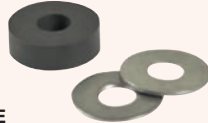

6410

SEAL SET ONE COMPLETE SEAL CHANGE

PART NUMBER	FOR USE WITH	SEALING RANGE	PRICE
FASFES0010050	FASFEM001	0.030" – 0.050"	£164.80
FASFES001001	FASFEM001	0.050" – 0.080"	£100.54
FASFES001002	FASFEM001	0.080" – 0.130"	£100.54
FASFES0101	FASFEM01	0.100" – 0.180"	£44.14
FASFES0102	FASFEM01	0.180" – 0.260"	£44.14
FASFES0103	FASFEM01	0.260" – 0.340"	£44.14
FASFES0104	FASFEM01	0.340" – 0.420"	£44.14
FASFES0105	FASFEM01	0.420" – 0.510"	£44.14
FASFES115	FASFEM1	0.433" – 0.512"	£50.27
FASFES116	FASFEM1	0.512" – 0.591"	£50.27
FASFES117	FASFEM1	0.591" – 0.669"	£50.27
FASFES118	FASFEM1	0.669" – 0.750"	£50.27
FASFES119	FASFEM1	0.750" – 0.827"	£50.27
FASFES221	FASFEM2	0.787" – 0.866"	£82.15
FASFES222	FASFEM2	0.866" – 0.945"	£82.15
FASFES223	FASFEM2	0.945" – 1.024"	£82.15
FASFES224	FASFEM2	1.024" – 1.102"	£82.15
FASFES225	FASFEM2	1.102" – 1.181"	£82.15
FASFES226	FASFEM2	1.181" – 1.260"	£82.15
FASFES227	FASFEM2	1.260" – 1.339"	£82.15
FASFES228	FASFEM2	1.339" – 1.417"	£82.15
FASFES229	FASFEM2	1.417" – 1.510"	£82.15
FASFES331	FASFEM3	1.496" – 1.614"	£155.71
FASFES332	FASFEM3	1.614" – 1.732"	£159.39
FASFES333	FASFEM3	1.732" – 1.850"	£159.39
FASFES334	FASFEM3	1.850" – 1.969"	£155.71
FASFES441	FASFEM4	1.969" – 2.087"	£187.59
FASFES442	FASFEM4	2.087" – 2.205"	£187.59
FASFES443	FASFEM4	2.205" – 2.323"	£187.59
FASFES444	FASFEM4	2.323" – 2.441"	£186.36
FASFES445	FASFEM4	2.441" – 2.559"	£186.36
FASFES446	FASFEM4	2.559" – 2.677"	£186.36
FASFES447	FASFEM4	2.677" – 2.795"	£186.36
FASFES448	FASFEM4	2.795" – 2.913"	£186.36
FASFES449	FASFEM4	2.913" – 3.032"	£186.36



6410

BULK SEAL SET 5 REPLACEMENT SEALS

PART NUMBER	FOR USE WITH	SEALING RANGE	PRICE
FASFEB0010050	FASFEM001	0.030" – 0.050"	£35.56
FASFEB001001	FASFEM001	0.050" – 0.080"	£35.56
FASFEB001002	FASFEM001	0.080" – 0.130"	£35.56
FASFEB0101	FASFEM01	0.100" – 0.180"	£61.30
FASFEB0102	FASFEM01	0.180" – 0.260"	£61.30
FASFEB0103	FASFEM01	0.260" – 0.340"	£61.30
FASFEB0104	FASFEM01	0.340" – 0.420"	£61.30
FASFEB0105	FASFEM01	0.420" – 0.510"	£61.30
FASFEB115	FASFEM1	0.433" – 0.512"	£63.76
FASFEB116	FASFEM1	0.512" – 0.591"	£63.76
FASFEB117	FASFEM1	0.591" – 0.669"	£63.76
FASFEB118	FASFEM1	0.669" – 0.750"	£63.76
FASFEB119	FASFEM1	0.750" – 0.827"	£63.76
FASFEB221	FASFEM2	0.787" – 0.866"	£198.62
FASFEB222	FASFEM2	0.866" – 0.945"	£198.62
FASFEB223	FASFEM2	0.945" – 1.024"	£198.62
FASFEB224	FASFEM2	1.024" – 1.102"	£198.62
FASFEB225	FASFEM2	1.102" – 1.181"	£198.62
FASFEB226	FASFEM2	1.181" – 1.260"	£198.62
FASFEB227	FASFEM2	1.260" – 1.339"	£198.62
FASFEB228	FASFEM2	1.339" – 1.417"	£198.62
FASFEB229	FASFEM2	1.417" – 1.510"	£198.62
FASFEB331	FASFEM3	1.496" – 1.614"	£405.83
FASFEB332	FASFEM3	1.614" – 1.732"	£405.83
FASFEB333	FASFEM3	1.732" – 1.850"	£405.83
FASFEB334	FASFEM3	1.850" – 1.969"	£405.83
FASFEB441	FASFEM4	1.969" – 2.087"	£548.06
FASFEB442	FASFEM4	2.087" – 2.205"	£548.06
FASFEB443	FASFEM4	2.205" – 2.323"	£548.06
FASFEB444	FASFEM4	2.323" – 2.441"	£548.06
FASFEB445	FASFEM4	2.441" – 2.559"	£548.06
FASFEB446	FASFEM4	2.559" – 2.677"	£548.06
FASFEB447	FASFEM4	2.677" – 2.795"	£548.06
FASFEB448	FASFEM4	2.795" – 2.913"	£548.06
FASFEB449	FASFEM4	2.913" – 3.032"	£548.06

PUR seals available on request

PUR seals available on request

DESCRIPTION

FasTest Internal FIM (metric) connectors provide fast, leak free connections for vacuum and pressure testing, fluid filling or flushing applications. The FI quick connectors seal internally to a wide variety of smooth or threaded tubes and the uniform seal movement makes a leak tight connection, even into threaded, rough and oily surfaces. The connectors are activated by compressed regulated air acting on a piston, which expands an elastomeric seal to form a leak free connection. Testing, filling or flushing of the piece is accomplished by introducing air, liquid or gas media through the connector. Ideal for automated processes and high volume production testing, the FI Series connectors are suited to pick and place parts handling applications.

FEATURES

- Pneumatic operation seals inside tubes and pipes
- Designed for production testing applications
- Pick and place parts handling
- Stroke limiter regulates seal expansion

SPECIFICATION

Connection method	Automated pneumatic
Connection type	Internal tubes / bores
Pressure rating	120 psi (8.2 bar)
Test pressure	Vacuum to 120 psi
Pilot operation	60 to 90 psi air supply

MATERIALS

Housing materials	Aluminium and stainless steel
Seal material	Neoprene

INTERNAL TUBE & THREAD CONNECTOR



6410

BASE CONNECTORS WITHOUT SEALS

PART NUMBER	SEALING SIZE	TERMINATION	BODY SIZE	PRICE
FASFIM01	0.310" – 0.394"	M5 x 0.8	01	£378.86
FASFIM1	0.394" – 0.630"	1/8" BSPP	1	£513.73
FASFIM2	0.630" – 0.866"	1/8" BSPP	2	£538.25
FASFIM3	0.866" – 1.102"	1/8" BSPP	3	£562.77
FASFIM4	1.102" – 1.339"	1/8" BSPP	4	£581.16
FASFIM5	1.339" – 1.693"	1/2" BSPP	5	£660.86
FASFIM6	1.693" – 2.165"	1/2" BSPP	6	£685.38

REPAIR KIT



6410

REPAIR KIT WITH SHAFTS AND NEOPRENE O-RINGS

PART NUMBER	FOR USE WITH	PRICE
FASFIR01	FASFIM01	£18.39
FASFIR1	FASFIM1, FASFIM2	£18.39
FASFIR3	FASFIM3, FASFIM4	£19.62
FASFIR6	FASFIM5, FASFIM6	£20.84
FASFIR7	FASFIM7, FASFIM8	£22.07

SEAL SETS



6410

SEAL SET ONE COMPLETE SEAL CHANGE

PART NUMBER	FOR USE WITH	SEALING RANGE	PRICE
FASFIS010300	FASFIM01	0.310" – 0.330"	£69.89
FASFIS0101	FASFIM01	0.330" – 0.394"	£36.78
FASFIS111	FASFIM1	0.394" – 0.472"	£44.14
FASFIS112	FASFIM1	0.472" – 0.551"	£44.14
FASFIS113	FASFIM1	0.551" – 0.630"	£44.14
FASFIS221	FASFIM2	0.630" – 0.709"	£44.14
FASFIS222	FASFIM2	0.709" – 0.787"	£44.14
FASFIS223	FASFIM2	0.787" – 0.866"	£44.14
FASFIS331	FASFIM3	0.866" – 0.945"	£55.17
FASFIS332	FASFIM3	0.945" – 1.024"	£55.17
FASFIS333	FASFIM3	1.024" – 1.102"	£55.17
FASFIS441	FASFIM4	1.102" – 1.181"	£55.17
FASFIS442	FASFIM4	1.181" – 1.260"	£55.17
FASFIS443	FASFIM4	1.260" – 1.339"	£55.17
FASFIS551	FASFIM5	1.339" – 1.457"	£110.35
FASFIS552	FASFIM5	1.457" – 1.575"	£110.35
FASFIS553	FASFIM5	1.575" – 1.693"	£110.35
FASFIS661	FASFIM6	1.693" – 1.850"	£122.61
FASFIS662	FASFIM6	1.850" – 2.008"	£122.61
FASFIS663	FASFIM6	2.008" – 2.165"	£122.61

PUR seals available on request

BULK SEAL SET 5 REPLACEMENT SEALS



6410

PART NUMBER	FOR USE WITH	SEALING RANGE	PRICE
FASFIB010300	FASFIM0101	0.310" - 0.330"	£121.38
FASFIB0101	FASFIM0101	0.330" - 0.394"	£69.89
FASFIB111	FASFIM111	0.394" - 0.472"	£71.11
FASFIB112	FASFIM112	0.472" - 0.551"	£71.11
FASFIB113	FASFIM113	0.551" - 0.630"	£71.11
FASFIB221	FASFIM221	0.630" - 0.709"	£72.34
FASFIB222	FASFIM222	0.709" - 0.787"	£72.34
FASFIB223	FASFIM223	0.787" - 0.866"	£72.34
FASFIB331	FASFIM331	0.866" - 0.945"	£109.12
FASFIB332	FASFIM332	0.945" - 1.024"	£109.12
FASFIB333	FASFIM333	1.024" - 1.102"	£109.12
FASFIB441	FASFIM441	1.102" - 1.181"	£109.12
FASFIB442	FASFIM442	1.181" - 1.260"	£109.12
FASFIB443	FASFIM443	1.260" - 1.339"	£109.14
FASFIB551	FASFIM551	1.339" - 1.457"	£286.90
FASFIB552	FASFIM552	1.457" - 1.575"	£286.90
FASFIB553	FASFIM553	1.575" - 1.693"	£286.90
FASFIB661	FASFIM661	1.693" - 1.850"	£286.90
FASFIB662	FASFIM662	1.850" - 2.008"	£286.90
FASFIB663	FASFIM663	2.008" - 2.165"	£286.90

PUR seals available on request

DESCRIPTION
ICON™ INTELLIGENT CONNECTION TECHNOLOGY

FasTest's ICON™ adds sensing capabilities to our mechanical sealing connection tools. ICON™ Tools include instant LED visual feedback and data output to improve sealing connection accuracy, maximise production efficiency, and optimise maintenance.

FE AND FI SERIES ICON™ CONNECTORS
ICON™ features:

SURE SEAL™

Instant LED feedback verifies a good connection prior to starting a test.

SEAL LIFE™

Alert when the main seal is at end of life and must be replaced.

System Overview:
CONNECTED

Green indication of a good connection.

RECONNECT

Recognize a connection issue before causing a false failure.

WORN SEAL

Alert when main seals should be replaced.

PICK TOOL

Controllable LED signals operator to use specific tool.

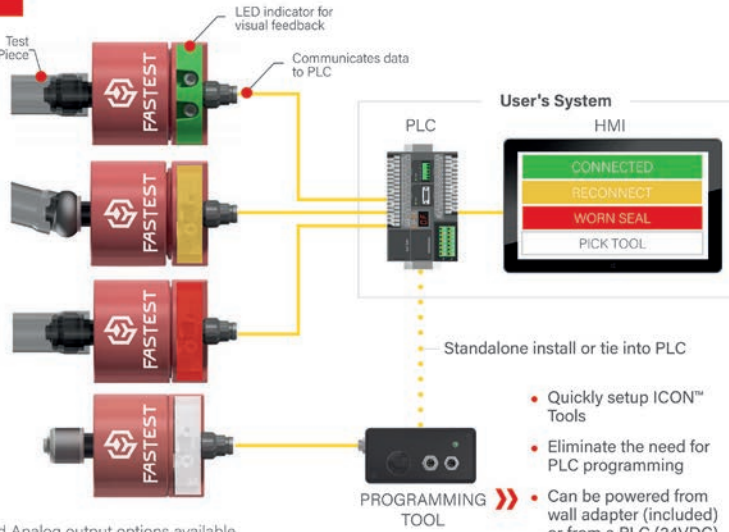

NOTE: Solid State Relay and Analog output options available.

How To Add ICON™ to FI

Signal Output	Part Number Suffix	Example
FI without ICON™	None	FI01
FI with ICON™: Analog Output Signal	CV04ANA	FI01CV04ANA
FI with ICON™: Solid State Relay	CV04SSR	FI01CV04SSR

FASMATE FX / FN SERIES ICON™ CONNECTORS
ICON™ features:

SURE SEAL™

Instant LED feedback verifies a good connection prior to starting a test.

System Overview:
CONNECTED

Verify connections are good prior to starting a leak test and provide operators instant positive feedback to simplify training.

RECONNECT

Recognize short connects before hazardous spills occur in functional testing, or prevent wasteful False Positive results in leak testing.

PICK TOOL

Controllable LED signals operator to use specific tool.

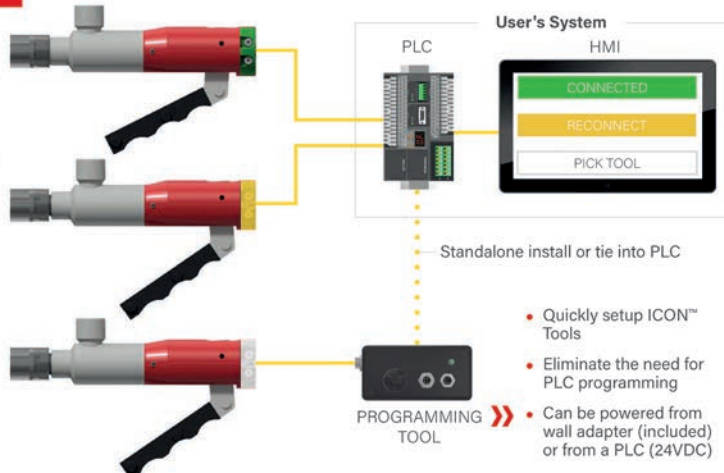

- Quickly setup ICON™ Tools
- Eliminate the need for PLC programming
- Can be powered from wall adapter (included) or from a PLC (24VDC)

JNL SERIES
DESCRIPTION

The JNL Series is ideal for internal connections to copper, steel and aluminium tubes used with manufacturing and refrigerant based products, such as heat exchangers, pressure vessels, gauges, valves, and HVAC-R systems. The unique collet gripping and sealing design seals reliably and resists removal under pressure. The single seal design can be quickly changed to minimise downtime, maintenance and tool inventory.

FEATURES

- Instant connections from vacuum (10 micron) to 1000 psi
- Seals straight bore, step bore, smooth or cast surfaces
- Safety design feature prevents accidental disconnect under pressure
- Collet design provides maximum grip with minimum distortion of test piece
- Neoprene seals are standard for refrigerant based applications, but also available with any elastomer required for your application

SPECIFICATION

Connection method	Lever actuated
Connection type	Internal tubes / bores
Pressure rating	68.8 bar (1000 psi)
Temperature range	-40°C to +121°C (-40°F to +250°F)

MATERIALS

Housing materials	Aluminium, stainless steel and Delrin
Seal material	Neoprene

INTERNAL TUBE & THREAD CONNECTOR

BASE CONNECTORS WITHOUT SEALS

6410

PART NUMBER	SEALING SIZE	TERMINATION	PRICE
FASJNL00375H	0.375"	1/8" NPT	£620.39
FASJNL00500H	0.500"	1/8" NPT	£620.39
FASJNL10625	0.625"	1/8" NPT	£620.39
FASJNL10750	0.750"	1/8" NPT	£627.75
FASJNL21000	1"	1/8" NPT	£865.83

SEAL SETS

BULK SEAL SET 5 REPLACEMENT SEALS

6410

PART NUMBER	FOR USE WITH	PRICE
FASSN00375H	FASJNL00375H	£46.59
FASSN00500H	FASJNL00500H	£46.59
FASSN10625	FASJNL10625	£46.59
FASSN10750	FASJNL10750	£46.59
FASSN21000	FASJNL21000	£46.59

JXL SERIES
DESCRIPTION

The JXL Series is ideal for external connections to copper, steel and aluminium tubes used with manufacturing and refrigerant based products, such as heat exchangers, pressure vessels, gauges, valves, and HVAC-R systems. The unique collet gripping and sealing design seals reliably and resists removal under pressure. The single seal design can be quickly changed to minimise downtime, maintenance and tool inventory.

FEATURES

- Instant connections from vacuum (10 micron) to 1000 psi
- Seals straight bore, step bore, smooth or cast surfaces
- Safety design feature prevents accidental disconnect under pressure
- Collet design provides maximum grip with minimum distortion of test piece
- Neoprene seals are standard for refrigerant based applications, but also available with any elastomer required for your application

SPECIFICATION

Connection method	Lever actuated
Connection type	Internal tubes / bores
Pressure rating	68.8 bar (1000 psi)
Temperature range	-40°C to +121°C (-40°F to +250°F)

MATERIALS

Housing materials	Aluminium, stainless steel and Delrin
Seal material	Neoprene

EXTERNAL TUBE & THREAD CONNECTOR

BASE CONNECTORS WITHOUT SEALS

6410

PART NUMBER	SEALING SIZE	TERMINATION	PRICE
FASJXL00250	0.250"	1/8" NPT	£237.86
FASJXL00375	0.375"	1/8" NPT	£247.67
FASJXL00500	0.500"	1/8" NPT	£268.51
FASJXL10625	0.625"	1/4" NPT	£673.12
FASJXL10750	0.750"	1/4" NPT	£771.20
FASJXL10875	0.875"	1/4" NPT	£807.98

SEAL SETS

BULK SEAL SET 5 REPLACEMENT SEALS

6410

PART NUMBER	FOR USE WITH	PRICE
FASSXL00250	FASJXL00250	£55.17
FASSXL00375	FASJXL00375	£55.17
FASSXL00500	FASJXL00500	£55.17
FASSXL10625	FASJXL10625	£55.17
FASSXL10750	FASJXL10750	£55.17
FASSXL10875	FASJXL10875	£55.17

DESCRIPTION

FasTest's patented squeeze lever actuation and split collet design, of the FasMate FN Series connectors, provides an instant connection that can significantly decrease the time needed for pressure and vacuum testing, filling, flushing and performance testing. The squeeze lever / split collet operation uses no thread sealant, no wrench tightening and will not damage the port threads. Its rugged design is ideal for production use and FN Series offers the following actuation methods: squeeze lever, pneumatic pilot or pneumatic thumb latch.

FEATURES

- Instant connection to threaded ports
- Seals to 5000 psi for pneumatic / hydraulic testing
- Safe, reliable, leak tight connection
- Eliminates thread or product damage, sealant and wrench tightening
- Durable stainless steel construction
- Available in multiple thread profiles

SPECIFICATION

Pressure rating	1/8" – 1/2": 5000 psi (345 bar) 3/4": 3500 psi (240 bar)
Max. side load rating	FN: 12.5 – 75 in-lbs (1.4 – 8.4 Nm) FX: 12.5 – 50 in-lbs (1.4 – 5.65 Nm) FNR: 9.38 – 28.13 in-lbs (1.06 – 3.18 Nm)
FNV/FNP pilot pressure	65 – 120 psi (4.5 to 8 bar)
FNV/FNP load rating	1/8" female NPT
MATERIALS	
Housing materials	Stainless steel and anodised aluminium
Seal material	Buna-N

EXTERNAL THREAD CONNECTORS
SQUEEZE LEVER OPERATION

CONNECTS TO / SEALS MALE BSPP
THREAD



6410

PART NUMBER	CONNECTS TO	TERMINATION	BODY SIZE	PRICE
FASFXL025041	1/8" BSPP	1/4" NPT	1	£1550.93
FASFXL045041	1/4" BSPP	1/4" NPT	1	£1531.37
FASFXL065061	3/8" BSPP	3/8" NPT	2	£1738.38
FASFXL085061	1/2" BSPP	3/8" NPT	2	£1653.98

CONNECTS TO / SEALS MALE BSPT THREAD

PART NUMBER	CONNECTS TO	TERMINATION	BODY SIZE	PRICE
FASFXL025T041	1/8" BSPT	1/4" NPT	1	£1550.93
FASFXL045T041	1/4" BSPT	1/4" NPT	1	£1550.93
FASFXL065T061	3/8" BSPT	3/8" NPT	2	£1738.38
FASFXL085T061	1/2" BSPT	3/8" NPT	2	£1738.38

PNEUMATIC PILOT OPERATION

CONNECTS TO MALE BSPP THREAD



6410

PART NUMBER	CONNECTS TO	TERMINATION	BODY SIZE	PRICE
FASFXP025041	1/8" BSPP	1/4" NPT	1	£1550.93
FASFXP045041	1/4" BSPP	1/4" NPT	1	£1550.93
FASFXP065061	3/8" BSPP	3/8" NPT	2	£1738.38
FASFXP085061	1/2" BSPP	3/8" NPT	2	£1738.38

CONNECTS TO MALE BSPT THREAD

PART NUMBER	CONNECTS TO	TERMINATION	BODY SIZE	PRICE
FASFXP025T041	1/8" BSPT	1/4" NPT	1	£1550.93
FASFXP045T041	1/4" BSPT	1/4" NPT	1	£1550.93
FASFXP065T061	3/8" BSPT	3/8" NPT	2	£1738.38
FASFXP085T061	1/2" BSPT	3/8" NPT	2	£1738.38

PNEUMATIC THUMB VALVE OPERATION

CONNECTS TO / SEALS MALE BSPP
THREAD



6410

PART NUMBER	CONNECTS TO	TERMINATION	BODY SIZE	PRICE
FASFXV025041	1/8" BSPP	1/4" NPT	1	£1550.93
FASFXV045041	1/4" BSPP	1/4" NPT	1	£1531.37
FASFXV065061	1/4" BSPP	1/4" NPT	2	£1738.38
FASFXV085061	1/2" BSPP	3/8" NPT	2	£1715.28

CONNECTS TO / SEALS MALE BSPT THREAD

PART NUMBER	CONNECTS TO	TERMINATION	BODY SIZE	PRICE
FASFXV025T041	1/8" BSPT	1/4" NPT	1	£1550.93
FASFXV045T041	1/4" BSPT	1/4" NPT	1	£1550.93
FASFXV065T061	3/8" BSPT	3/8" NPT	2	£1738.38
FASFXV085T061	1/2" BSPT	3/8" NPT	2	£1738.38

REPLACEMENT SEAL SET

SEAL SET
5 REPLACEMENT SEALS
BUNA-N



6410

PART NUMBER	FOR USE WITH	PRICE
FASS1105B70	1/8" threads	£33.10
FASS1108B70	1/4" threads	£33.10
FASS1110B70	3/8" threads	£36.78
FASS1112B70	1/2" threads	£38.01

PUR seals available on request

REPAIR KIT

REPAIR KIT

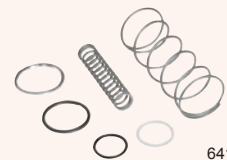

6410

PART NUMBER	FOR USE WITH	PRICE
FASRFXL021	1/8" threads	£128.11
FASRFXL041	1/4" threads	£115.25
FASRFXL061	3/8" threads	£103.84
FASRFXL081	1/2" threads	£115.98

INTERNAL THREAD CONNECTORS

SQUEEZE LEVER OPERATION
CONNECTS TO FEMALE BSPP PORTS

6410

PART NUMBER	CONNECTS TO	TERMINATION	BODY SIZE	PRICE
FASFNL026025	1/8" BSPP	1/8" BSPP	1	£884.00
FASFNL046045	1/4" BSPP	1/4" BSPP	2	£884.00
FASFNL066065	3/8" BSPP	3/8" BSPP	3	£989.44
FASFNL086085	1/2" BSPP	1/2" BSPP	4	£1149.40
FASFNL126125	3/4" BSPP	3/4" BSPP	5	£1528.44

CONNECTS TO FEMALE BSPT PORTS

PART NUMBER	CONNECTS TO	TERMINATION	BODY SIZE	PRICE
FASFNL026T025	1/8" BSPT	1/8" BSPT	1	£884.00
FASFNL046T045	1/4" BSPT	1/4" BSPT	2	£884.00
FASFNL066T065	3/8" BSPT	3/8" BSPT	3	£989.44
FASFNL086T085	1/2" BSPT	1/2" BSPT	4	£1089.98
FASFNL126T125	3/4" BSPT	3/4" BSPT	5	£1983.59

CONNECTS TO FEMALE METRIC PORTS

PART NUMBER	CONNECTS TO	TERMINATION	BODY SIZE	PRICE
FASFNL108025	M10 x 1.0	1/8" BSPP	1	£884.00
FASFNL128045	M12 x 1.5	1/4" BSPP	2	£884.00
FASFNL148045	M14 x 1.5	1/4" BSPP	2	£884.00
FASFNL168065	M16 x 1.5	3/8" BSPP	3	£989.44
FASFNL188065	M18 x 1.5	3/8" BSPP	4	£1065.42
FASFNL208065	M20 x 1.5	3/8" BSPP	4	£1065.42
FASFNL228085	M22 x 1.5	1/2" BSPP	4	£1258.28

PNEUMATIC PILOT OPERATION
CONNECTS TO FEMALE BSPP PORTS

6410

PART NUMBER	CONNECTS TO	TERMINATION	BODY SIZE	PRICE
FASFNP026025	1/8" BSPP	1/8" BSPP	1	£887.40
FASFNP046045	1/4" BSPP	1/4" BSPP	2	£887.40
FASFNP066065	3/8" BSPP	3/8" BSPP	3	£993.93
FASFNP086085	1/2" BSPP	1/2" BSPP	4	£1140.94
FASFNP126125	3/4" BSPP	3/4" BSPP	5	£1517.21

CONNECTS TO FEMALE BSPT PORTS

PART NUMBER	CONNECTS TO	TERMINATION	BODY SIZE	PRICE
FASFNP026T025	1/8" BSPT	1/8" BSPT	1	£887.40
FASFNP046T045	1/4" BSPT	1/4" BSPT	2	£887.40
FASFNP066T065	3/8" BSPT	3/8" BSPT	3	£993.93
FASFNP086T085	1/2" BSPT	1/2" BSPT	4	£1081.61
FASFNP126T125	3/4" BSPT	3/4" BSPT	5	£1969.00

CONNECTS FEMALE TO METRIC PORTS

PART NUMBER	CONNECTS TO	TERMINATION	BODY SIZE	PRICE
FASFNP108025	M10 x 1.0	1/8" BSPP	1	£887.40
FASFNP128045	M12 x 1.5	1/4" BSPP	2	£884.00
FASFNP148045	M14 x 1.5	1/4" BSPP	2	£887.40
FASFNP168065	M16 x 1.5	3/8" BSPP	3	£993.93
FASFNP188065	M18 x 1.5	3/8" BSPP	4	£1065.42
FASFNP208065	M20 x 1.5	3/8" BSPP	4	£1065.42
FASFNP228085	M22 x 1.5	1/2" BSPP	4	£1258.28

PNEUMATIC THUMB VALVE OPERATION
CONNECTS TO FEMALE BSPP PORTS

6410

PART NUMBER	CONNECTS TO	TERMINATION	BODY SIZE	PRICE
FASFNV026025	1/8" BSPP	1/8" BSPP	1	£884.00
FASFNV046045	1/4" BSPP	1/4" BSPP	2	£884.00
FASFNV066065	3/8" BSPP	3/8" BSPP	3	£993.93
FASFNV086085	1/2" BSPP	1/2" BSPP	4	£1140.94
FASFNV126125	3/4" BSPP	3/4" BSPP	5	£1517.21

CONNECTS TO FEMALE BSPT PORTS

PART NUMBER	CONNECTS TO	TERMINATION	BODY SIZE	PRICE
FASFNV026T025	1/8" BSPT	1/8" BSPT	1	£887.40
FASFNV046T045	1/4" BSPT	1/4" BSPT	2	£884.00
FASFNV066T065	3/8" BSPT	3/8" BSPT	3	£993.93
FASFNV086T085	1/2" BSPT	1/2" BSPT	4	£1074.04
FASFNV126T125	3/4" BSPT	3/4" BSPT	5	£1969.00

CONNECTS TO FEMALE METRIC PORTS

PART NUMBER	CONNECTS TO	TERMINATION	BODY SIZE	PRICE
FASFNV108025	M10 x 1.0	1/8" BSPP	1	£884.00
FASFNV128045	M12 x 1.5	1/4" BSPP	2	£884.00
FASFNV148045	M14 x 1.5	1/4" BSPP	2	£887.40
FASFNV168065	M16 x 1.5	3/8" BSPP	3	£993.93
FASFNV188065	M18 x 1.5	3/8" BSPP	4	£1065.42
FASFNV208065	M20 x 1.5	3/8" BSPP	4	£1065.42
FASFNV228085	M22 x 1.5	1/2" BSPP	4	£1258.28

REPLACEMENT SEAL SET

SEAL SET
5 REPLACEMENT SEALS
BUNA-N

6410

PART NUMBER	FOR USE WITH	PRICE
FASS1108B70	1/8" & M10 threads	£33.10
FASS21250327B60	1/4", M12 & M14 threads	£39.23
FASS1112B70	3/8" threads	£38.01
FASS1208B70	1/2" threads	£38.01
FASS1315B70	3/4" threads	£44.14
FASS21200445B70	M16 threads	£36.78
FASS1206B70	M18 threads	£38.01
FASS1207B70	M20 threads	£38.01
FASS1209B70	M22 threads	£40.46

PUR seals available on request

DESCRIPTION

TwistMate's unique "twist to connect" and pressure assisted grip and seal is simple to use. Turn finger-tight onto thread until face seal contacts test piece. TwistMate will automatically seal when the system is pressurised with air, gas or hydraulic pressure that presses the main seal against the test piece. The internal piston action maintains the seal with minimum pressure. TwistMate connectors are not designed for or intended as permanent connections. Such use may result in inadvertent loosening and media loss.

FEATURES

- For vacuum or pressure test applications up to 10,000 psi (689 bar)
- Eliminates tape, sealants and operator fatigue from traditional wrenching methods
- Reduces wear on test piece and prevents contamination of media
- Easy to use with operator adjustment necessary
- Rugged stainless steel construction endures demanding production environments

APPLICATIONS

- Leak testing – water dunk, pressure decay, helium mass spectrometer
- Calibration, filling, pressure and proof testing
- Ideal for piping, cooling, heating, fluid, hydraulic, pneumatic, refrigerant and fittings
- Eliminates tape, sealants, wrenches and damage to threaded parts
- Durable, easy to replace main seal

SPECIFICATION

Connection type	External threads (female)
Connection method	Twist to connect

MATERIALS

Seals	Urethane
-------	----------

MET EXTERNAL THREAD CONNECTORS
**SWIVEL CONNECTOR
CONNECTS TO / SEALS
MALE BSPP THREADS**

6410

PART NUMBER	CONNECTS TO / SEALS	TERMINATION (FEMALE)	PRESSURE RATING	PRICE
FASMET025025	1/8" BSPP	1/8" BSPP	5000 psi	£109.12
FASMET045045	1/4" BSPP	1/4" BSPP	5000 psi	£350.66
FASMET065065	3/8" BSPP	3/8" BSPP	4000 psi	POA
FASMET085085	1/2" BSPP	1/2" BSPP	4000 psi	POA

**CAP
CONNECTS TO / SEALS
MALE BSPP THREADS**

6410

PART NUMBER	CONNECTS TO / SEALS	PRESSURE RATING	PRICE
FASMET025C	1/8" BSPP	5000 psi	POA
FASMET045C	1/4" BSPP	5000 psi	£141.00
FASMET065C	3/8" BSPP	4000 psi	POA
FASMET085C	1/2" BSPP	4000 psi	POA

CONNECTS TO / SEALS MALE BSPT THREADS

PART NUMBER	CONNECTS TO / SEALS	TERMINATION (FEMALE)	PRESSURE RATING	PRICE
FASMET025T025	1/8" BSPT	1/8" BSPT	4000 psi	POA
FASMET045T045	1/4" BSPT	1/4" BSPT	5000 psi	POA
FASMET065T065	3/8" BSPT	3/8" BSPT	4000 psi	POA
FASMET085T085	1/2" BSPT	1/2" BSPT	4000 psi	POA

CONNECTS TO / SEALS MALE BSPT THREADS

PART NUMBER	CONNECTS TO / SEALS	PRESSURE RATING	PRICE
FASMET025TC	1/8" BSPT	5000 psi	POA
FASMET045TC	1/4" BSPT	5000 psi	POA
FASMET065TC	3/8" BSPT	4000 psi	POA
FASMET085TC	1/2" BSPT	4000 psi	POA

MET REPLACEMENT SEAL SET
**SEAL SET
5 REPLACEMENT SEALS
URETHANE**

6410

PART NUMBER	FOR USE WITH	PRICE
FASS1105U70	1/8" threads	£33.10
FASS1108U70	1/4" threads	£33.10
FASS1110U70	3/8" threads	£36.78
FASS1112U70	1/2" threads	£38.01

PUR seals available on request

MET REPAIR KIT
EXTERNAL REPAIR KIT

6410

PART NUMBER	FOR USE WITH	PRICE
FASMETR02	1/8" threads	£18.39
FASMETR04	1/4" threads	£18.39
FASMETR06	3/8" threads	£22.07
FASMETR08	1/2" threads	£22.07

MIT INTERNAL THREAD CONNECTORS
**SWIVEL CONNECTOR
CONNECTS TO / SEALS
FEMALE BSPP PORTS**

6410

PART NUMBER	CONNECTS TO / SEALS	TERMINATION (FEMALE)	PRESSURE RATING	PRICE
FASMIT026025	1/8" BSPP	1/8" BSPP	5000 psi	£169.20
FASMIT046045	1/4" BSPP	1/4" BSPP	5000 psi	£619.01
FASMIT066065	3/8" BSPP	3/8" BSPP	4000 psi	POA
FASMIT086085	1/2" BSPP	1/2" BSPP	4000 psi	POA
FASMIT126125	3/4" BSPP	3/4" BSPP	4000 psi	£1114.65
FASMIT166165	1" BSPP	1" BSPP	4000 psi	£1371.17

CONNECTS TO / SEALS FEMALE BSPT PORTS

PART NUMBER	CONNECTS TO / SEALS	TERMINATION (FEMALE)	PRESSURE RATING	PRICE
FASMIT026T025	1/8" BSPT	1/8" BSPT	5000 psi	POA
FASMIT046T045	1/4" BSPT	1/4" BSPT	5000 psi	POA
FASMIT066T065	3/8" BSPT	3/8" BSPT	4000 psi	POA
FASMIT086T085	1/2" BSPT	1/2" BSPT	4000 psi	POA
FASMIT126T125	3/4" BSPT	3/4" BSPT	4000 psi	POA
FASMIT166T165	1" BSPT	1" BSPT	4000 psi	POA

CONNECTS TO / SEALS FEMALE METRIC PORTS

PART NUMBER	CONNECTS TO / SEALS	TERMINATION (FEMALE)	PRESSURE RATING	PRICE
FASMIT108025	M10 x 1.0	1/8" BSPP	5000 psi	£172.63
FASMIT128045	M12 x 1.5	1/4" BSPP	5000 psi	POA
FASMIT148045	M14 x 1.5	1/4" BSPP	5000 psi	POA
FASMIT168045	M16 x 1.5	3/8" BSPP	4000 psi	POA
FASMIT188065	M18 x 1.5	3/8" BSPP	4000 psi	POA
FASMIT228085	M22 x 1.5	1/2" BSPP	4000 psi	£802.44

**PLUG
CONNECTS TO / SEALS
FEMALE BSPP PORTS**

6410

PART NUMBER	CONNECTS TO / SEALS	PRESSURE RATING	PRICE
FASMIT026P	1/8" BSPP	5000 psi	POA
FASMIT046P	1/4" BSPP	5000 psi	POA
FASMIT066P	3/8" BSPP	4000 psi	£200.98
FASMIT086P	1/2" BSPP	4000 psi	£163.95
FASMIT126P	3/4" BSPP	4000 psi	£394.04
FASMIT166P	1" BSPP	4000 psi	£439.65

CONNECTS TO / SEALS FEMALE BSPT PORTS

PART NUMBER	CONNECTS TO / SEALS	PRESSURE RATING	PRICE
FASMIT026TP	1/8" BSPT	5000 psi	POA
FASMIT046TP	1/4" BSPT	5000 psi	£109.12
FASMIT066TP	3/8" BSPT	4000 psi	£196.91
FASMIT086TP	1/2" BSPT	4000 psi	POA
FASMIT126TP	3/4" BSPT	4000 psi	£313.88
FASMIT166TP	1" BSPT	4000 psi	£366.60

CONNECTS TO / SEALS FEMALE METRIC PORTS

PART NUMBER	CONNECTS TO / SEALS	PRESSURE RATING	PRICE
FASMIT108P	M10 x 1.0	5000 psi	POA
FASMIT128P	M12 x 1.5	5000 psi	POA
FASMIT148P	M14 x 1.5	5000 psi	£368.18
FASMIT168P	M16 x 1.5	4000 psi	POA
FASMIT188P	M18 x 1.5	4000 psi	£268.38
FASMIT228P	M22 x 1.5	4000 psi	POA

**NON-SWIVEL CONNECTOR
CONNECTS TO / SEALS
FEMALE BSPP PORTS**

6410

PART NUMBER	CONNECTS TO / SEALS	TERMINATION (FEMALE)	PRESSURE RATING	PRICE
FASMIT026025X	1/8" BSPP	1/8" BSPP	5000 psi	£120.16
FASMIT046045X	1/4" BSPP	1/4" BSPP	5000 psi	£303.44
FASMIT066065X	3/8" BSPP	3/8" BSPP	4000 psi	£215.52
FASMIT086085X	1/2" BSPP	1/2" BSPP	4000 psi	£170.42
FASMIT126125X	3/4" BSPP	3/4" BSPP	4000 psi	£313.88
FASMIT166165X	1" BSPP	1" BSPP	4000 psi	£819.97

CONNECTS TO / SEALS FEMALE BSPT PORTS

PART NUMBER	CONNECTS TO / SEALS	TERMINATION (FEMALE)	PRESSURE RATING	PRICE
FASMIT026T025X	1/8" BSPT	1/8" BSPT	5000 psi	£124.07
FASMIT046T045X	1/4" BSPT	1/4" BSPT	5000 psi	£149.70
FASMIT066T065X	3/8" BSPT	3/8" BSPT	4000 psi	£219.82
FASMIT086T085X	1/2" BSPT	1/2" BSPT	4000 psi	POA
FASMIT126T125X	3/4" BSPT	3/4" BSPT	4000 psi	POA
FASMIT166T165X	1" BSPT	1" BSPT	4000 psi	POA

MIT REPLACEMENT SEAL SET

6410

**SEAL SET
5 REPLACEMENT SEALS
URETHANE**

PART NUMBER	FOR USE WITH	PRICE
FASS1109U70	1/8" threads	£33.10
FASS1111U70	1/4" threads	£36.78
FASS1113U70	3/8" threads	£38.01
FASS1209U70	1/2" threads	£40.46

PUR seals available on request

MIT REPAIR KIT

6410

**INTERNAL REPAIR KIT
FOR SWIVEL CONNECTOR**

PART NUMBER	FOR USE WITH	PRICE
FASMITR020	1/8" and M10 threads	£17.17
FASMITR040	1/4" and M12 threads	£17.17
FASMITR060	3/8" and M14 threads	£17.17
FASMITR080	1/2" and M16 threads	£17.17
FASMITR120	3/4" and M18 threads	£20.84
FASMITR160	1" and M22 threads	£23.30

FOR NON-SWIVEL CONNECTOR

PART NUMBER	FOR USE WITH	PRICE
FASMITR02	1/8" threads	£13.49
FASMITR04	1/4" threads	£13.49
FASMITR06	3/8" threads	£13.49
FASMITR08	1/2" threads	£13.49
FASMITR12	3/4" threads	£15.94
FASMITR16	1" threads	£17.17
FASMITR20	1 1/4" threads	£20.84